



Invoice to:  
Name:  
Street:  
Town: Postal code:  
E-Mail:  
Tel: Fax:

---

Order date:  
Purchase order:  
Number required:

**CE** Deliver to:  
Name:  
Street:  
Town: Postal code:  
E-Mail:  
Tel: Fax:

---

Marked for:  
  
Sunrise order no:

● = Standard    □ = Cost option    ○ = No cost option

Customer service fax number 01384 44 66 44  
Order online at: [www.sunscript.co.uk](http://www.sunscript.co.uk)

Max. user weight: **120 kg**  
**USER WEIGHT**  kg

Mandatory information to ensure correct configuration

Part. no.: 066001

**Base price** £1,895 €3,083

**CLIENT MEASUREMENT**

**Seat width in cm**

Seat depth in cm	Seat width in cm									SD 34-38cm have the frame length of SD 38cm
	32	34	36	38	40	42	44	46	48	
34	<input type="radio"/>	<input type="radio"/>	<input type="radio"/>	<input type="radio"/>	<input type="radio"/>	<input type="radio"/>	<input type="radio"/>	<input type="radio"/>	<input type="radio"/>	
36	<input type="radio"/>	<input type="radio"/>	<input type="radio"/>	<input type="radio"/>	<input type="radio"/>	<input type="radio"/>	<input type="radio"/>	<input type="radio"/>	<input type="radio"/>	
38	<input type="radio"/>	<input type="radio"/>	<input type="radio"/>	<input type="radio"/>	<input type="radio"/>	<input type="radio"/>	<input type="radio"/>	<input type="radio"/>	<input type="radio"/>	
40	<input type="radio"/>	<input type="radio"/>	<input type="radio"/>	<input type="radio"/>	<input type="radio"/>	<input type="radio"/>	<input type="radio"/>	<input type="radio"/>	<input type="radio"/>	
42	<input type="radio"/>	<input type="radio"/>	<input type="radio"/>	<input type="radio"/>	<input type="radio"/>	<input type="radio"/>	<input type="radio"/>	<input type="radio"/>	<input type="radio"/>	
44	<input type="radio"/>	<input type="radio"/>	<input type="radio"/>	<input type="radio"/>	<input type="radio"/>	<input type="radio"/>	<input type="radio"/>	<input type="radio"/>	<input type="radio"/>	
46	<input type="radio"/>	<input type="radio"/>	<input type="radio"/>	<input type="radio"/>	<input type="radio"/>	<input type="radio"/>	<input type="radio"/>	<input type="radio"/>	<input type="radio"/>	
48	<input type="radio"/>	<input type="radio"/>	<input type="radio"/>	<input type="radio"/>	<input type="radio"/>	<input type="radio"/>	<input type="radio"/>	<input type="radio"/>	<input type="radio"/>	

Your rear seat height can only be between 0 cm and 13 cm below your front seat height:

i.e. rear seat height CANNOT be above front seat height

i.e. rear seat height CANNOT be more than 13 cm below front seat height

- More info, see first back page

# 4" & 5" soft roll and 5" & 6" soft solid are only available with a 45 mm fork

Please note the measurement of seat depth is from the back post

- All measurements are in cm and without a cushion

High frame is 4 cm higher than low frame and you can choose shorter and lighter forks to minimize the weight of your wheelchair. See next page

**Front seat height in cm**

Front Castor	Fork (length x width)	Frame:	Front seat height in cm														
			42	43	44	45	46	47	48	49	50	51	52	53	54	55	56
3"	98 mm x 32 mm	Low		<input type="radio"/>	<input type="radio"/>	<input type="radio"/>											
	111 mm x 32 mm	Low			<input type="radio"/>	<input type="radio"/>	<input type="radio"/>										
	98 mm x 32 mm	High						<input type="radio"/>	<input type="radio"/>	<input type="radio"/>							
	111 mm x 32 mm	High							<input type="radio"/>	<input type="radio"/>	<input type="radio"/>						
4"	111 mm x 45 mm	Low				<input type="radio"/>	<input type="radio"/>	<input type="radio"/>									
	123 mm x 45 mm	Low				<input type="radio"/>	<input type="radio"/>	<input type="radio"/>	<input type="radio"/>								
	98 mm x 32 mm	Low			<input type="radio"/>	<input type="radio"/>	<input type="radio"/>										
	111 mm x 32 mm	Low				<input type="radio"/>	<input type="radio"/>	<input type="radio"/>									
	111 mm x 45 mm	High							<input type="radio"/>	<input type="radio"/>	<input type="radio"/>						
	123 mm x 45 mm	High								<input type="radio"/>	<input type="radio"/>	<input type="radio"/>	<input type="radio"/>				
5"	98 mm x 32 mm	High								<input type="radio"/>	<input type="radio"/>	<input type="radio"/>					
	111 mm x 32 mm	High								<input type="radio"/>	<input type="radio"/>	<input type="radio"/>	<input type="radio"/>				
	111 mm x 45 mm	High									<input type="radio"/>	<input type="radio"/>	<input type="radio"/>	<input type="radio"/>			
	123 mm x 45 mm	High										<input type="radio"/>	<input type="radio"/>	<input type="radio"/>	<input type="radio"/>		
	98 mm x 32 mm	High										<input type="radio"/>	<input type="radio"/>	<input type="radio"/>			
	111 mm x 32 mm	High										<input type="radio"/>	<input type="radio"/>	<input type="radio"/>	<input type="radio"/>		
6"	123 mm x 45 mm	Low										<input type="radio"/>	<input type="radio"/>				
	123 mm x 45 mm	High												<input type="radio"/>	<input type="radio"/>		



Standard design  
98 mm, 111 mm, 32 mm width



Standard design  
111 mm  
123 mm, 45 mm width

**Please follow measuring method:**

The following method is recommended on the basis of extensive practical experience.

Deviations are possible in individual instances

**Seat width:**

**a) For the user:**

Allow space between side guard and hip on each side of the chair (approx. 1 - 2 cm all together).



**b) On the wheelchair:**

From outside frame tube to outside frame tube

**Seat depth:**

**a) For the user:**

When sitting upright: leave space for 2-3 fingers between front edge of seat upholstery and back of knee (approx. 3-6 cm). Care must be taken with adjustable upholstery.

**b) On the wheelchair:**

From back tube to front of seat upholstery.

**Back height:**

**a) For the user:**

Measured from the seat, including cushion, to be **no more** than one finger (1 - 2 cm) below the lower shoulder blade.

**Important!** The back height depends on the degree of disability.

**b) On the wheelchair:**

From seat tube to upper edge of backrest upholstery.

**Note:** The user's ability to sit upright has a major influence on the back height and it can therefore vary considerably.

**Lower leg length (LLL):**

**a) For the user:**

With legs angled at right angles, from back of knee to bottom of shoe sole.

**Remember: to deduct the cushion height when providing the measurement**

**b) On the wheelchair:**

From front of seat to top of footrest.

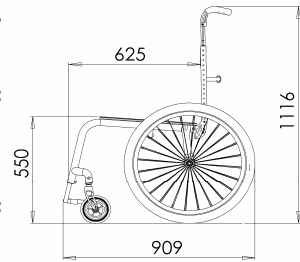
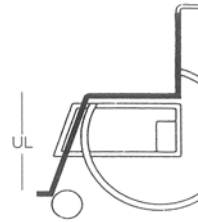
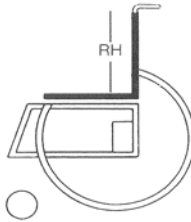
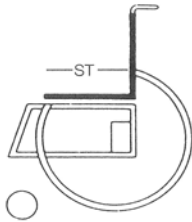
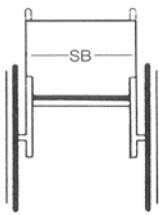

**Overall width:**

Overall width:  
Max overall height 112cm  
Max overall length 91cm

**Overall width with:**

For 0° camber:	24"	SW+20cm	25"	SW+20cm
For 3° camber:		SW+22cm		SW+26cm
For 6° camber:		SW+28cm		SW+32cm

**Weights:**

Minimum weight: each with hand rim distance std from 6.44kg

Please note that the matrix is based on a std configuration  
**Std chair 40 x 40 cm, 3° camber, 5.60 cm CoG**  
**Seat angle of 8°**  
 All changes in the configuration might change the seat heights.  
 Manufacturing tolerances of +/- 1 cm  
**NOTES:**  
 Max seat height difference rear to front is 13 cm.  
 No negative seat angle is possible  
**Please note that the matrix is based on a standard configuration**

**Low seat frame vs. High seat frame**

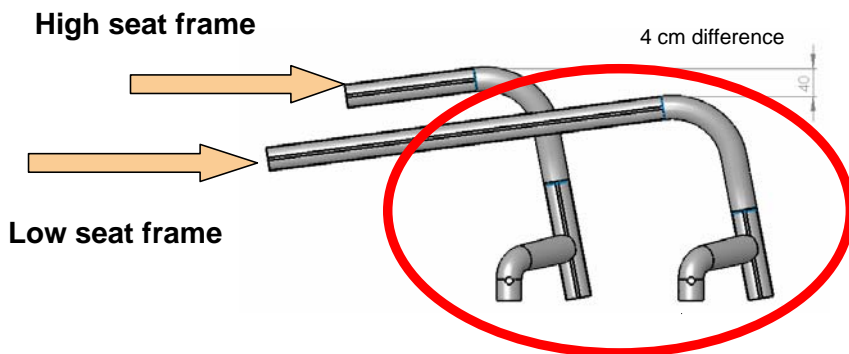

# QUICKIE Helium

● = Standard    ○ = No cost option    □ = Cost option

Rear wheel	Rear seat height in cm <small>(the ordered rear seat height is adjustable +/- 1 cm on each chair) (1)</small>																				
	Wheels	Axle plate:	34	35	36	37	38	39	40	41	42	43	44	45	46	47	48	49	50	51	52
	24"					○	○	○	○	○	○	○	○	○	○	○	○	○	○	○	○
25"						○	○	○	○	○	○	○	○	○	○	○	○	○	○	○	○

SEAT UPHOLSTERY			
<b>Seat Sling Standard (2)</b>			
3002	○	With 1 Utility bag	
3006	□	With two utility bags	<small>(only from SW 34 cm)</small> 38.00 61.83
3005	□	With one utility bag plus one catheter bag	<small>(only from SW 34 cm)</small> 60.00 97.62
3020	□	<b>Seat Sling Clip Style (Airflow) (user weight limit 100kg) (2)</b>	137.00 222.90
3014	□	With 1 Utility bag	170.00 276.59
3017	□	With two utility bags	<small>(only from SW 34 cm)</small> 192.00 312.38
3018	□	With one utility bag plus one catheter bag	<small>(only from SW 34 cm)</small> 214.00 348.18
3001	○	Without seat sling	
<b>Seat cushion with cover, black</b>			
3026	a)	Foam composite Thickness: □ 3 cm □ 5 cm <small>(medium)</small>	46.00 74.84
3027	b)	Latex Thickness: □ 5 cm □ 8 cm <small>(very soft)</small>	46.00 74.84
<b>Seat cushion with water resistant / breathable cover</b>			
3028	a)	Foam composite Thickness: □ 3 cm □ 5 cm <small>(medium)</small>	87.00 141.55
3029	b)	Latex Thickness: □ 5 cm □ 8 cm <small>(very soft)</small>	87.00 141.55
<b>Seat accessories</b>			
4049	□	Positioning belt with lock	30.00 48.81
3003	□	Spare cushion cover with zipper	32.00 52.06

For more JAY information please call Customer Services on 01384 446666 or see JAY order forms

BACKREST													
<b>Backrest (JAY compatible)</b>		<b>25 - 30cm</b>	<b>30 - 40cm</b>	<b>40 - 45cm</b>	<small>(height adjustable)</small>								
○	<b>Standard adjustable backrest</b>	○ 25	○ 30	○ 40									
	<b>Back height factory set at (cm)</b>	○ 27.5	○ 32.5    ○ 37.5	○ 42.5									
		○ 30	○ 35    ○ 40	○ 45									
□	<b>Oval shaped backrest (OSB)</b>	<small>(oval and narrow towel bar, non height adjustable)</small>											
4067	□	25	27.5	30	32.5	35	37.5	40	42.5	45	165.00	268.46	
4029	○	Foldable, angle adjustable standard, single locking <small>(-31° to +15°) (only in black anodizing)</small>											
4018	○	Angle adjustable fixed (non foldable) <small>(-31° to +15°)</small>											
4016	□	Double locking function (locks also in the folded position) <small>(-31° to +15°)</small>										38.00	61.83
4068	□	Backrest ONE size smaller than standard (SW - 2 cm)										110.00	178.97



Pushhandles			
4054	○	Without pushhandles	
4042	○	Short	
4022	○	Long	
4024	□	Fold-down pushhandles <small>(only available from 32.5 cm standard back)</small>	95.00 154.57
4034	□	Height-adjustable pushhandles <small>(Not possible with OSB (4067) &amp; from 32.5cm on std back only)</small>	127.00 206.63
4043	□	JAY 3 Hardware height-adjustable pushhandles <b>NEW OPTION</b>	127.00 206.63

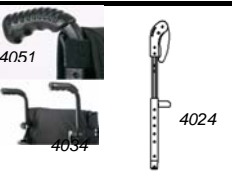

Backrest upholstery			
4032	○	Adjustable backrest upholstery (nylon) <b>(3) IMPROVED DESIGN</b>	
4069	□	Air flow (lightweight) adj backrest upholstery <b>IMPROVED DESIGN</b>	165.00 268.46
4038	□	Adjustable backrest with vented material □ Black □ Silver <b>(3)</b>	110.00 178.97
4070	□	Comfort upholstery <b>(3)</b> □ Grey □ Brown <small>(adjustable backrest with Alcantara material)</small>	274.00 445.80
4031	□	Without back upholstery	

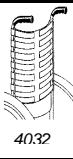

SIDEGUARDS/ARMREST			
4247	□	Slim style carbon fibre sideguard <b>(4)</b>	<small>(slim style, carbon fibre)</small> 216.00 351.43
4229	□	Straight sideguard aluminium <b>IMPROVED DESIGN</b>	167.00 271.71
4238	□	Fender sideguard aluminium <b>IMPROVED DESIGN</b>	<small>(min seat height 39 cm)</small> 180.00 292.86
4232	□	Fender sideguard carbon fibre <b>IMPROVED DESIGN</b>	<small>(min seat height 39 cm)</small> 236.00 383.97
4263	□	Plastic sideguard detachable <b>(5) NEW OPTION</b>	<small>(Quickie style)</small> 122.00 198.49
4264	□	Single post height adjustable armrest <b>(6 &amp; 7) NEW OPTION</b>	<small>(Quickie style)</small> 126.00 205.00



LEGREST & FOOTPLATES			
Footplates			
2106	○	Lightweight tubular footrest <small>(lower leg length between 36 cm - 52.5 cm)</small>	
2105	□	Lightweight tubular footrest with flat cover <small>(lower leg length between 36 cm - 52.5 cm)</small>	55.00 89.49
2101		Platform footrest angle and depth adjustable □ Aluminium footplate in frame colour □ Composite Footplate	110.00 178.97
2097	□	Performance platform footrest angle adjustable <small>(lower leg length between 36 cm - 52.5 cm)</small>	165.00 268.46
2102	□	High mounted platform footplates, aluminium <small>(high mounted for lower leg length between 22 - 39 cm)</small>	110.00 178.97
2133	□	Foot positioning plate <small>(only in combination with 2101 &amp; 2102)</small>	49.00 79.72

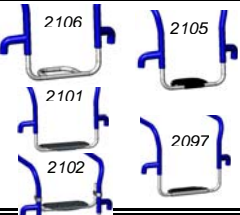

(1): note with 37 cm and 49 cm with 24" rear wheel/no additional decline or increase of the seat possible  
 note with 38 cm and 50 cm with 25" rear wheel/no additional decline or increase of seat height possible  
 (2): No change from std to clipstyle seat sling possible (and visa versa) possible in the field  
 (3): reduces the seat depths of approx 1cm due to padding  
 (4): with 24" rear wheel minimum rear seat height 41cm; with 25" rear wheel minimum rear seat height 43cm  
 (5): Not with COG 9.2 & 10.4cm in combination with lightweight upholstery  
 (6): Not in combination with COG 8, 9.2 & 10.4cm in combination with lightweight seat upholstery  
 (7): Not in combination with compact lightweight wheel lock

For more information visit our webpage [www.sunrisemedical.com](http://www.sunrisemedical.com)

© Sunrise Medical 2010  
 OF-Helium-UK RETAIL 1st November 2010 REV 5  
 Page 3 of 8

### Frame inset table

Seat width		32	34	36	38	40	42	44	46
Inset									
0 cm		27	29	31	33	35	37	39	41
3cm each side		XXX	23	25	27	29	31	33	35

34 cm Seat width

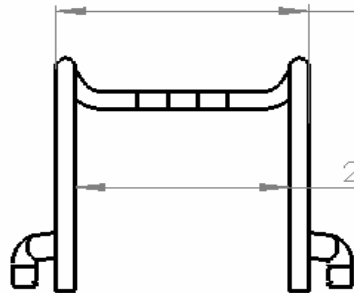

29 cm Frame inside

34 cm Seat width

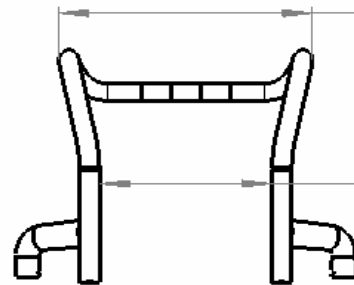

23 cm Frame inside

Lower Leg Length on the HIGH FRAME						Lower Leg Length on the LOW FRAME					
LOWER LEG LENGTH	TUBULAR FOOTREST w/o cover	PERFORMANCE FOOTREST	ALUMINUM FOOTREST	PLASTIC FOOTREST	HIGH MOUNTED FOOTREST	LOWER LEG LENGTH	TUBULAR FOOTREST w/o cover	PERFORMANCE FOOTREST	ALUMINUM FOOTREST	PLASTIC FOOTREST	HIGH MOUNTED FOOTREST
22	NO GO	NO GO	NO GO	NO GO	X	22	NO GO	NO GO	NO GO	NO GO	X
23	NO GO	NO GO	NO GO	NO GO	X	23	NO GO	NO GO	NO GO	NO GO	X
24	NO GO	NO GO	NO GO	NO GO	X	24	NO GO	NO GO	NO GO	NO GO	X
25	NO GO	NO GO	NO GO	NO GO	X	25	NO GO	NO GO	NO GO	NO GO	X
26	NO GO	NO GO	NO GO	NO GO	X	26	NO GO	NO GO	NO GO	NO GO	X
27	NO GO	NO GO	NO GO	NO GO	X	27	NO GO	NO GO	NO GO	NO GO	X
28	NO GO	NO GO	NO GO	NO GO	X	28	NO GO	NO GO	NO GO	NO GO	X
29	NO GO	NO GO	NO GO	NO GO	X	29	NO GO	NO GO	NO GO	NO GO	X
30	NO GO	NO GO	NO GO	NO GO	X	30	NO GO	NO GO	NO GO	NO GO	X
31	NO GO	NO GO	NO GO	NO GO	X	31	NO GO	NO GO	NO GO	NO GO	X
32	NO GO	NO GO	NO GO	NO GO	X	32	NO GO	NO GO	NO GO	NO GO	X
33	NO GO	NO GO	NO GO	NO GO	X	33	NO GO	NO GO	NO GO	NO GO	X
34	NO GO	NO GO	NO GO	NO GO	X	34	NO GO	NO GO	NO GO	NO GO	X
35	NO GO	NO GO	NO GO	NO GO	X	35	NO GO	NO GO	NO GO	NO GO	X
36	X	X	X	X	NO GO	36	NO GO	NO GO	NO GO	NO GO	X
37	X	X	X	X	NO GO	37	NO GO	NO GO	NO GO	NO GO	X
38	X	X	X	X	NO GO	38	NO GO	NO GO	NO GO	NO GO	X
39	X	X	X	X	NO GO	39	NO GO	NO GO	NO GO	NO GO	X
40	X	X	X	X	NO GO	40	X	X	X	X	NO GO
41	X	X	X	X	NO GO	41	X	X	X	X	NO GO
42	X	X	X	X	NO GO	42	X	X	X	X	NO GO
43	X	X	X	X	NO GO	43	X	X	X	X	NO GO
44	X	X	X	X	NO GO	44	X	X	X	X	NO GO
45	X	X	X	X	NO GO	45	X	X	X	X	NO GO
46	X	X	X	X	NO GO	46	X	X	X	X	NO GO
47	X	X	X	X	NO GO	47	X	X	X	X	NO GO
48	X	X	X	X	NO GO	48	X	X	X	X	NO GO
49	X	X	X	X	NO GO	49	X	X	X	X	NO GO
50	X	X	X	X	NO GO	50	X	X	X	X	NO GO
51	X	X	X	X	NO GO	51	X	X	X	X	NO GO
52	X	X	X	X	NO GO	52	X	X	X	X	NO GO

**QUICKIE Helium**

● = Standard ○ = No cost option □ = Cost option

£ €

<b>Lower leg length (LLL)</b>		<i>(Attention: LLL has to be 2,5 cm less than seat height front)</i>		<i>(please refer to back page 1)</i>	
○ 22	○ 23	○ 24	○ 25	○ 26	○ 27
○ 30	○ 31	○ 32	○ 33	○ 34	○ 35
○ 38	○ 39	○ 40	○ 41	○ 42	○ 43
○ 46	○ 47	○ 48	○ 50	○ 51	○ 52
(seat to footplate)					
<b>All measurements are in cm</b>					

<b>FRAME</b>				
1232 ○	Std frame knee angle 100° (80° for UK)	<b>(1)</b>		
1231 □	Helium performance knee angle 92° (88° for UK)	<b>(2)</b>	82.00	133.41
1280	Frame inset	<i>(each side of the frame)</i>	<i>(please refer to the frame inset table)</i>	
○	Std inset (0cm)			
1282 □	Helium performance inset (3cm)		82.00	133.41
<i>(not available for seat width 32 cm)</i>				

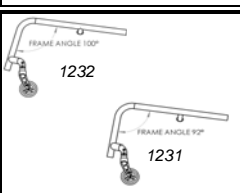

<b>CENTRE OF GRAVITY (COG) &amp; AXLE PLUG</b>				
<i>(all measurements are in cm)</i>			<i>(choose only one option)</i>	
Choose only one of the 8 choices			<b>When choosing COG less than 5.6 axle adaptor is used</b>	
○ 2,00 cm	○ 4,40 cm	○ 6,80 cm	○ 9,20 cm	
○ 3,20 cm	○ 5,60 cm	○ 8,00 cm	○ 10,40 cm	

<b>FRAME ACCESSORIES</b>			<i>(choose either tip assist or anti- tip tubes, not both)</i>	
5184 □	<b>Suspension (3)</b>	□ user weight - 70kgs HLM0800	□ user weight - 120kgs HLM080019	322.00 523.89
<b>Tip assist (step tube)</b>				
1230 □	Left	1230 □ Right		22.00 35.79
1205 □	Crutch holder with Velcro		<i>(only in combination with 1230)</i>	49.00 79.72
<b>Anti-tip tubes, swing-away</b>				
1244 □	Left	1244 □ Right		65.00 105.76
1244 □	Pair			128.00 208.26
1245 □	Quickie style anti-tip tubes pluggable		<i>(pair)</i>	55.00 89.49
1247 □	Transit wheel			144.00 234.29
1281 □	Frame protection			49.00 79.72

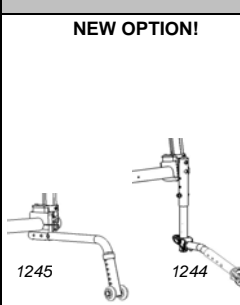

<b>STANDARD CASTOR</b>			<i>(compare with your choice on the first page)</i>	
5812 ○	Solid			
5823 ○	Soft solid	<i>(for 45 mm fork version only)</i>	<i>(only for 5" &amp; 6")</i>	
<b>Light ups</b>				
5850 □	Solid		<i>(not available for 6")</i>	49.00 79.72
<b>Castor with aluminium rim</b>				
5852 □	Solid		<i>(only for 4" and 5")</i>	58.00 94.37
5855 □	Soft roll castor with aluminium rim wide version	<i>(for 45 mm fork version only)</i>	<i>(only for 4" and 5")</i>	58.00 94.37

<b>REAR WHEELS</b>			<i>(compare with your choice on the first page; choose only one wheel type)</i>	
<i>NOTE: for users with higher user weight than 100 kg, we recommend cross spoked wheels</i>				
5172 ○	Cross spoked	<i>(pair)</i>	<i>(only 24")</i>	
5137 ○	Design wheel	<i>(pair)</i>	<i>(only 24")</i>	
5140 ○	24" Light weight wheel	<b>(4)</b>	<i>(pair)</i>	
5140 □	25" Light weight wheel	<b>(4)</b>	<i>(pair)</i>	151.00 245.68
5181 □	Proton wheel (super-lightweight)	<b>(4)</b>	<i>(pair)</i>	<i>(user weight limit 100kg)</i>
5159 □	Spinergy wheels	<b>(5)</b>	<i>(pair)</i>	324.00 527.15
5162 □	Mountain bike wheel		<i>(only with 24", mountain bike tyres &amp; aluminium rim, black coated)</i>	230.00 374.21
5162 □	Additional mountain bike wheel pair		<i>(only with 24" &amp; mountain bike tyres )</i>	346.00 562.94

<b>TYRES</b>			<i>(choose only one tyre type)</i>	
5125 ○	Right Run		<i>(only 24")</i>	
5167 □	2" grip		<i>(only 24")</i>	66.00 107.38
5118 □	Speedrun		<i>(- this is the lightest tyre option, NA Spinergy wheels)</i>	66.00 107.38
5168 ○	Solid tyres		<i>(only 24" ;NA Lightweight or Spinergy wheels)</i>	
5164 □	Marathon plus evolution		<i>(puncture resistant, adds approximatley 800g per chair)</i>	66.00 107.38



<b>HANDRIM</b>			<i>(Not required for Spinergy or Mountain bike wheel)</i>	
5144 ○	Aluminium silver powdercoated			
5142 ○	Aluminium silver anodized			
5183 □	Coloured aluminium pushrim. Specify colour code: .....		46.00	74.84
5174 ○	Stainless steel	<b>(6)</b>	<i>(only 24"wheels)</i>	
5122 □	Titanium		<i>(only 24"wheels)</i>	137.00 222.90
5121 □	Titanium clear powdercoated		<i>(only 24"wheels)</i>	137.00 222.90
5120 □	Supergrip	<b>(6)</b>	<i>(only 24"wheels)</i>	165.00 268.46
□	Maxgrepp	<b>NEW OPTION</b>	<i>(only 24"wheels)</i>	165.00 268.46
	Handrim mounting	○ Standard = 17mm	○ Wide = 27mm	
		○ Close = 7mm	<i>(only with stainless steel)</i>	
5178 □	Handrim cover		<i>(only 24")</i>	66.00 107.38

Maxgrepp handrims combine greater comfort with minimal effort, even for those with impaired hand function, through the ergonomic profile of the tube and the high friction, latex free rubber coating

(1): all castor sizes can be used and changed afterwards in the field

(2): no change from 3"or4" castors to 5" or 6" castors in the field

(4): not in combination with solid tyres(5168)

(5): not available with spokeguards

(6): not available with light weight or Porton wheels

OF-Helium-UK RETAIL 1st November 2010 REV 5

For more information  
visit our webpage  
[www.sunrisemedical.com](http://www.sunrisemedical.com)

© Sunrise Medical 2010

Page 5 of 8

NoGo Matrix Lightweight brake

Seat height values are valid with 56 mm COG, seat depth 400 mm and 8° seat angle, axle stem assembled with one spacer

**SD 42 - 48**

24"	Front Seat Height													25"	Front Seat Height												
Cog/ S	43	44	45	46	47	48	49	50	51	52	53	54	55	Cog/ S	43	44	45	46	47	48	49	50	51	52	53	54	55
2														2													
3.2														3.2													
4.4														4.4													
5.6														5.6													
6.8														6.8													
8														8													
9.2														9.2													
10.4														10.4													

**SD 40**

24"	Front Seat Height													25"	Front Seat Height												
Cog/ S	43	44	45	46	47	48	49	50	51	52	53	54	55	Cog/ S	43	44	45	46	47	48	49	50	51	52	53	54	55
2														2													
3.2														3.2													
4.4														4.4													
5.6														5.6													
6.8														6.8													
8														8													
9.2														9.2													
10.4														10.4													

**SD 34 - 38**

24"	Front Seat Height													25"	Front Seat Height												
Cog/ S	43	44	45	46	47	48	49	50	51	52	53	54	55	Cog/ S	43	44	45	46	47	48	49	50	51	52	53	54	55
2														2													
3.2														3.2													
4.4														4.4													
5.6														5.6													
6.8														6.8													
8														8													
9.2														9.2													
10.4														10.4													

 Possible

 NoGo

**QUICKIE Helium**

● = Standard    ○ = No cost option    □ = Cost option

£    €

**WHEEL CAMBER**

(choose only one option)

5161 ○ 0°    5161 ○ 3°    5161 ○ 6°

**Spoke guard**

Please refer to brochure and provide number/description

(only available in 24")

□ Spoke guards    Number    Description    90.00    146.43

Please consult the following page of this order form to choose your selection, or to order a copy of our new brochure please call 01384 446666 or e-mail [literaturerequests@sunmed.co.uk](mailto:literaturerequests@sunmed.co.uk). You can also view the brochure on-line by visiting [www.sunrisemedical.com](http://www.sunrisemedical.com) and navigating to Quickie Helium. You will find the brochure under "Multimedia & Downloads"

**WHEEL LOCKS**

(choose only one option)

6009	○	Standard wheel lock		
6008	□	Knee lever wheel lock	44.00	71.59
6003	□	Compact wheel lock	44.00	71.59
6011	□	Compact lightweight wheel lock	110.00	178.97
6016	□	Extension for knee lever wheel lock, slip-on, swing-away	30.00	48.81

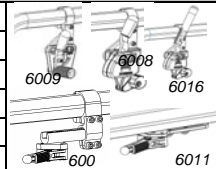

**ACCESSORIES**

●	Tool kit			
1402	□	High pressure pump	55.00	89.49
1403	□	Air pump	11.00	17.90
4006	□	Back pack	44.00	71.59
1405	□	Net back bag	16.00	26.03
2118	□	Bag caddy (3)	44.00	71.59
2113	□	Mobile phone pouch	33.00	53.69



**COLOURS**

Please consult our colour catalogue to choose your colour selections. To order please call 01384 446666 or e-mail [literaturerequests@sunmed.co.uk](mailto:literaturerequests@sunmed.co.uk)

		Frame			Handrim			Hub/rim					Frame			Handrim			Hub/rim																				
				£46.00	74.84 €	£127.00	€206.63									£46.00	74.84 €	£127.00	€206.63																				
01	White RAL 9010	○						18	Illusion Lapis	□	£101.00	€164.33																											
32	Signal White(crystal white)	○						19	Brilliant Purple	○																													
02	Brilliant Silver	○						20	Matt Purple	□	£69.00	€112.26																											
04	Silver	○						21	Red Ruby	○																													
06	Sun Yellow	○						22	Brilliant Red	○																													
07	Brilliant Lime	○						23	Matt Red	□	£69.00	€112.26																											
08	Matt Lime	□	£69.00	€112.26				25	Amethyst Fanta	□	£101.00	€164.33																											
09	Candy Teal	○						26	Silver Texture	○																													
10	Matt Candy Teal	□	£69.00	€112.26				27	Graphite Metall	○																													
12	Forest Green	○						28	Platinum Metall	○																													
13	Flip Flop Blue / Green	□	£101.00	€164.33				29	Black	○																													
14	Blue	○						30	Mystery	□	£101.00	€164.33																											
15	Brilliant Marine	○							Matt Black	□	£69.00	€112.26																											
16	Matt Marine	□	£69.00	€112.26																																			

**Anodized colour package for fork and backbracket**

03	Silver Matt	□ (4)		£66.00	€107.38
24	Tutti Frutti Orange	□ (4)			
29	Black	○			

- (1) not available with 6° camber - Please check nogo matrix
- (2) COG adjustment in the field of 4cm only
- (3) not in combination with performance footrest or high mounted footrest
- (4) not available with the std back angle adjustment, single locking

**Comments for special build:**



**Helium - Base Price**

Option price	
Exclusive VAT	
VAT.	
<b>Total Price</b>	

Sunrise Medical Customer Services  
 High St, Wollaston, Stourbridge, DY8 4PS  
 Tel. 01384 446666  
 Fax. 01384 446644

E-mail: [orders@sunmed.co.uk](mailto:orders@sunmed.co.uk)  
 Order online at: [www.sunscript.co.uk](http://www.sunscript.co.uk)

For more information visit our website  
[www.sunrisemedical.com](http://www.sunrisemedical.com)  
 © Sunrise Medical 2010

**SPOKE GUARDS - 24" ONLY**



5000 - Princess Life



5001- Dancing Bear



5002 - Jungle Fever



5004 - Happy Lions



5005 - Water World



5006- Randolph



5007 -Monkeys



5008 - Pirates



5015 - Feather

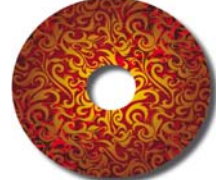

5025 - Oriental



5012 - Racing



5014 - Dirt Race



5003 - Superhero



5018 - Graffiti



5017 - Chrome Wheel



5016 - Hot Wheels



5023 - Basketball



5024 - Basketball 2



5013 - Pool



5022 - Flying Water



5021 - Space



5020 - Silk



5011 - Abstract



5019 - Creative



5009 - Tiger



5010 - Zebra



5135 - Cheese



5129 - Bibbo



5134 - Galactica



5127 - Rotation



5130 - Fantasy



5128 - Graphic